



WWW.BARRYIND.COM

TV0805CB-XXXXJN-91

Alumina

Features:

- ◆ Alumina Material
- ◆ DC - 3 GHz Performance
- ◆ 2 Watt Input Power
- ◆ Solder Mountable
- ◆ CB - Tin Lead over Nickel over Silver

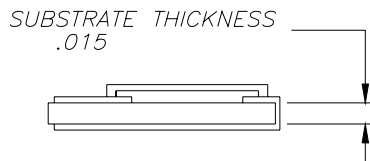
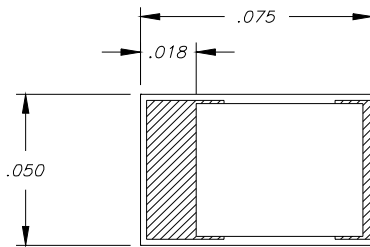

Dimensions in inches
Tolerance $\pm .005$
unless otherwise stated

CHIP TERMINATION

General Description:

The TV0805CB-XXXX*JN-91 is a solder mountable chip termination. It has an input power of 2 watts, while maintaining a constant mounting surface temperature of 100°C. It offers a frequency range from DC - 3 GHz.

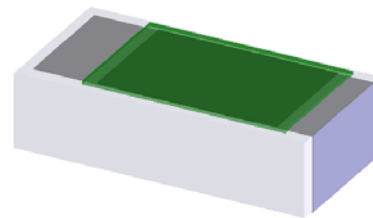

* XXXX = Resistance Value in Ohms

- Ohms
- 0.5...R500
 - 11R00
 - 10.....10R0
 - 50.....50R0
 - 100...1000
 - 150...1500
 - 1K.....1001
 - 10K...1002
 - 100K.1003
 - 470K.4703
 - 1M....1004

Sample part number:
TV0805CB-50R0JN-91

DERATING CURVE:

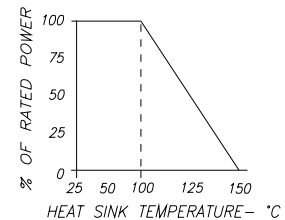

Parameter	Min.	Typ.	Max.	Units
Frequency Range	DC		3	GHz
Resistance		+/- 5%		
Input Return Loss	25			dB
Input Power			2	Watts
Mounting Surface Temperature			100	°C

Barry Industries reserves the right to change part number and or process without notification.

Barry Industries, Inc., 60 Walton St., Attleboro, MA 02703 T: 508-226-3350 F: 508-226-3317 E-mail: sales@barryind.com

Barry Industries maintains an ISO 9001 Certified Quality Management System

Origination Date	Revision Date	Rev.
10/29/03	06/30/08	B