



WWW.BARRYIND.COM

RS2335CT-XXXX*GN-99



BeO

CHIP RESISTOR

Features:

- ◆ BeO Material
- ◆ 50 Watt Input Power
- ◆ Flip Chip Configuration
- ◆ CT - Matte Tin over Nickel over Silver
- ◆ Solder Mountable

General Description:

The RS2335CT-XXXX*GN-99 is a BeO flip chip resistor. It has an input power of 50 watts, while maintaining a constant mounting surface temperature of 100°C. Its compact size is ideal for miniature electronic components.

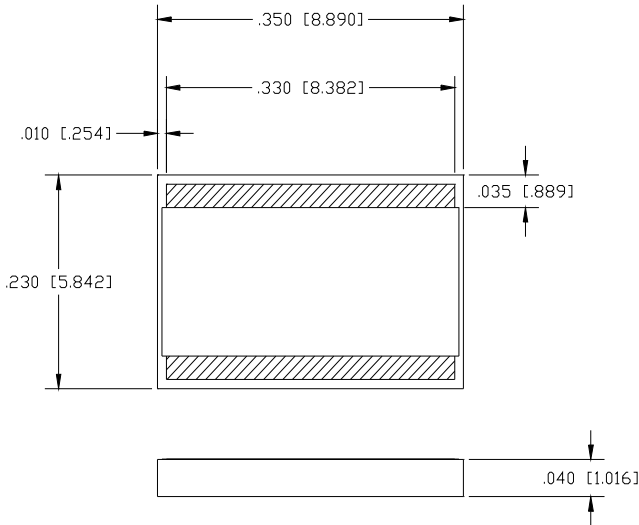

Dimensions in inches [mm]
Tolerance $\pm .005$ [.127]
unless otherwise stated

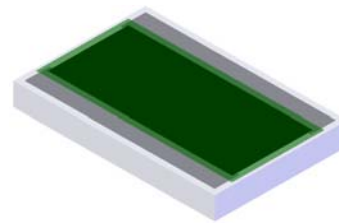

* XXXX = Resistance Value in Ohms
.5 - 1Mohm available
Sample Part Number = RS2335CT-50R0GN-99

- 0.5...R500
- 11R00
- 10.....10R0
- 50.....50R0
- 100...1000
- 150...1500
- 1K.....1001
- 10K...1002
- 100K.1003
- 470K.4703
- 1M...1004

DERATING CURVE:

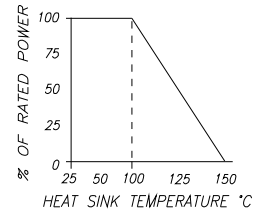

Parameter	Min.	Typ.	Max.	Units
Input Power			50	Watts
Resistance		+/- 2%		Ohms
Mounting Surface Temperature			100	°C

Barry Industries reserves the right to change part number and or process without notification.

Barry Industries, Inc., 60 Walton St., Attleboro, MA 02703 T: 508-226-3350 F: 508-226-3317 E-mail: sales@barryind.com
Barry Industries maintains an ISO 9001 Certified Quality Management System

Origination Date	Revision Date	Rev.
12/23/08	12/23/08	-