



WWW.BARRYIND.COM

# R1000-20-12X



## BeO

## FLANGED RESISTOR

### Features:

- ◆ BeO Material
- ◆ 20 Watt Input Power
- ◆ Flange Mount

### General Description:

The R1000-20-12X is a flanged 100 ohm, BeO resistor. It offers an input power of 20 watts, while maintaining a constant flange temperature of 100°C.

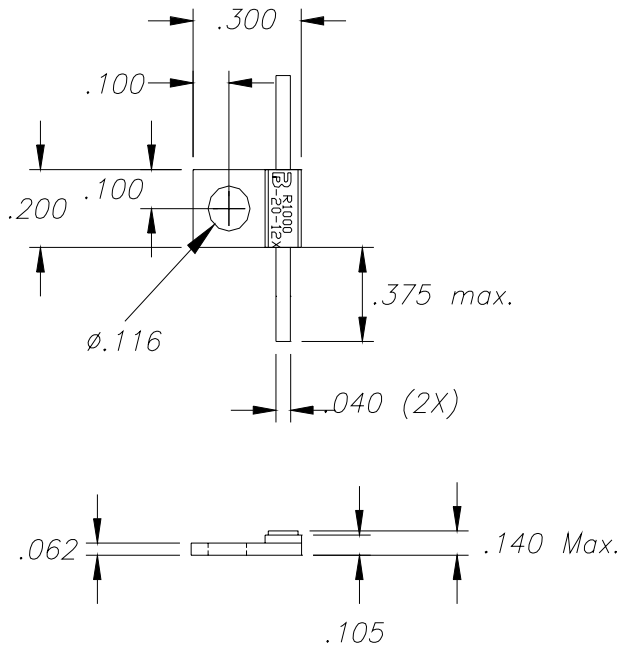

Dimensions in inches  
Tolerance  $\pm .010$   
unless otherwise stated

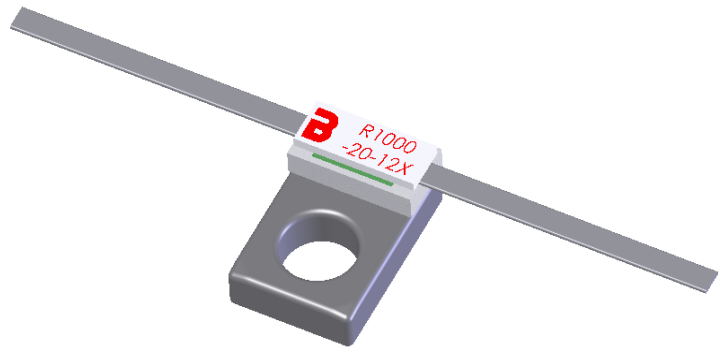

DERATING CURVE:

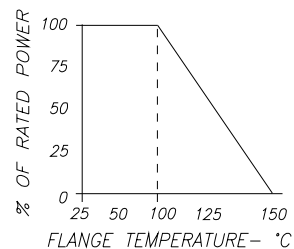

Parameter	Min.	Typ.	Max.	Units
Input Power			20	Watts
Resistance	95	100	105	Ohms
Flange Temperature			100	°C

Barry Industries reserves the right to change part number and or process without notification.

Barry Industries, Inc., 60 Walton St., Attleboro, MA 02703 T: 508-226-3350 F: 508-226-3317 E-mail: sales@barryind.com  
Barry Industries maintains an ISO 9001 Certified Quality Management System

Origination Date	Revision Date	Rev.
03/19/08	03/19/08	-